

REV	REVISION RECORD	ECN	BY	APVD	DATE
A	INITIAL RELEASE	14183	MAC	JB	6-28-96
B	PER ECN 14471	14471	MAC	JB	11-28-96
C	ADDED NEW PLATINGS TO FINISH	500166	MAC	JB	01-28-97

NOTE: UNLESS OTHERWISE SPECIFIED

1. INTERPRET DRAWING IN ACCORDANCE WITH ANSI Y14.5-1982.
2. REMOVED
3. PITCH CONSISTENCY TO BE WITHIN ± 0.005 OVER 3.000 INCHES.
- \triangle PART TO BE SUPPLIED ON A CONTINUOUS REEL.
5. ALL DIMENSIONS APPLY AFTER PLATING.

PART NUMBER BREAKDOWN

- 0 = UNDER 1 INCH OAL.
- 1 = OVER 1 INCH OAL.

PIN SIZE

8-45

OVERALL LENGTH "L"

PIN LENGTH "P" ABOVE STAR

PIN TYPE (SEE STAR DETAIL)

- 1 = SQUARE PIN
- 2 = SQUARE PIN WITH STANDARD STAR

FINISH VARIATIONS

- AA = TIN/LEAD .000120 MIN OVER NICKEL
- BB = GOLD PLATE .000005 OVER NICKEL
- CC = GOLD PLATE .000010 OVER NICKEL
- WW = GOLD PLATE .000015 OVER NICKEL
- DD = GOLD PLATE .000020 OVER NICKEL
- EE = GOLD PLATE .000030 OVER NICKEL
- FF = GOLD .000030 OVER Pd-Ni .000012 OVER NICKEL
- NN = NICKEL PLATE .000050
- RR = UNPLATED

MATERIAL

- 2 = BRASS ALLOY
- 5 = PHOSPHOR BRONZE ALLOY
- 7 = COPPER/NICKEL/TIN ALLOY

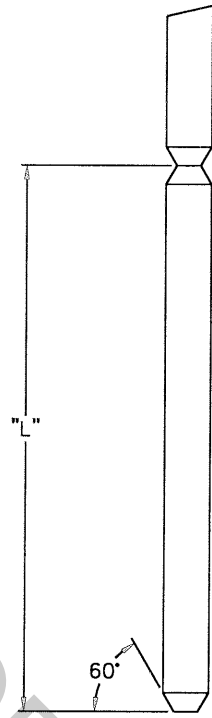

PIN WITH NO STAR

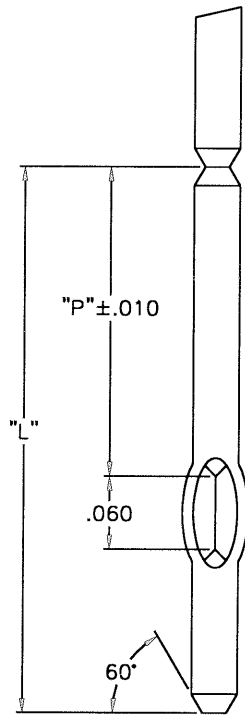

PIN WITH STAR

\triangle REELING ORIENTATION AP/2 REEL (24" O.D. x 20" I.D.)

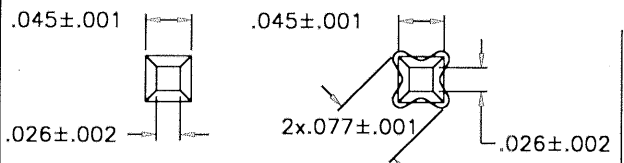
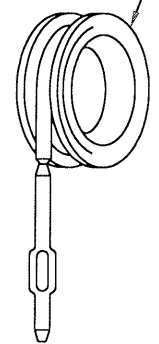

- 1 SQUARE NO STAR
- 2 SQUARE STD. STAR

STAR DETAIL

CUSTOMER DRAWING

This drawing and the information set forth herein are the property of Autossplice, Inc. and are to be held in trust and confidence. Publication, duplication, disclosure, or use for any purpose not expressly authorized in writing by Autossplice, Inc. is prohibited.

ALL DIMENSIONS ARE IN INCHES			AUTOSPLICE INC. 10121 Barnes Canyon Road San Diego, California 92121 (619) 333-0077
	DECIMAL: XX = ± 0.1 XXX = ± 0.005	THIRD ANGLE PROJECTION	DRAWN BY MAC M DATE 6-05-96 APPROVED BY J BIANCA DATE 6-05-96
ANGULAR: $\pm 5^\circ$	Dwg. FSCM NO. C 0AE89 SCALE: NONE	REV. NO. C8-45[1 thru 2] CAD FILE NO. C08-451-2XX AND REV.	SHEET 1 OF 1